



DOUGHTY ENGINEERING LTD

DATA SHEET

TITLE: DOUGHTY SLIMLINE L/W
HALF COUPLER 30MM

PART NOS:
T58080 - SILVER
T58081 - BLACK

MATERIAL :
ALUMINIUM

WEIGHT:
0.24 KG

SWL:
300 KG

FINISH:
T58080 - POLISHED
T58081 - POWDER PAINTED BLACK

NOTES:
MIN TUBE SIZE - 48MM
MAX TUBE SIZE - 51MM

STRICTLY FOR REFERENCE PURPOSES ONLY

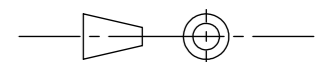

THIRD ANGLE PROJECTION

MIN TUBE SIZE 48MM
MAX TUBE SIZE 51MM

